

## INSTALLATION INSTRUCTIONS

### Brackets for Suspended Ceilings | TBSS

#### Required System Parts

- Qty. 1 Flexible Hose (EFB or EFU)
- Qty. 2 TBSS Side Brackets
- Qty. 1 Stock Bar (25" or 50")
- Qty. 1 SBB Center Bracket

#### Required Tools

- Pipe Wrench
- PTFE Tape



**WARNING**

- You must read and understand all instructions and warnings before attempting to install any EASYFLEX Sprinkler Drops system.
- Failure to follow these instructions could cause improper operation resulting in serious personal injury.
- We recommend to wear safety glasses, a hardhat, and foot protection during installation.

- 1 Inspect the EASYFLEX sprinkler drop system components for any sign of physical damage. Make sure all components are in proper place.



Disconnect the Inlet Nipple and Outlet Reducer from the Flexible Hose and check that a Sealing Gasket is in each place properly. Reconnect Outlet Reducer to the Flexible Hose.



- 2 Apply 7 to 10 wraps of PTFE tape on the Inlet Nipple Thread. Use pipe Wrench to connect the Inlet Nipple to the branch line. Torque range should be a minimum of 50 to maximum of 58 ft·lbs. Make sure both end threads are clean without any damage.



- 3 Use the pipe wrench to connect the Flexible Hose to the Outlet Nipple. Torque range should be a minimum of 50 to a maximum of 58 ft·lbs.

**DO NOT** use PTFE tape on the Outlet Nipple thread to connect to the Flexible Hose.



- 4** Slide down TBSS mounting bracket into the T-Bar ceiling grid till the clip is fully latched onto the T-Bar. Hand tighten the wing bolt on the TBSS bracket to tightly secure the end bracket at the required position.

**DO NOT** over tighten wing bolt with tools, and the wing bolt should be at horizontal position as the picture.

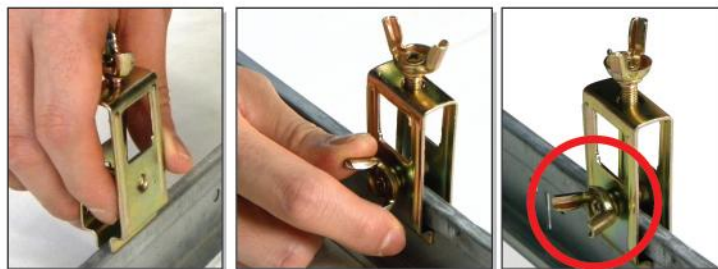

- 5** Insert stock bar (SQ25 or SQ50) into the TBSS end brackets. Adjust the stock bar for proper position and hand screw down the wing bolt to tightly screw the stock bar in place.



- 6** Hook the center bracket named "SBB" onto the stock bar.

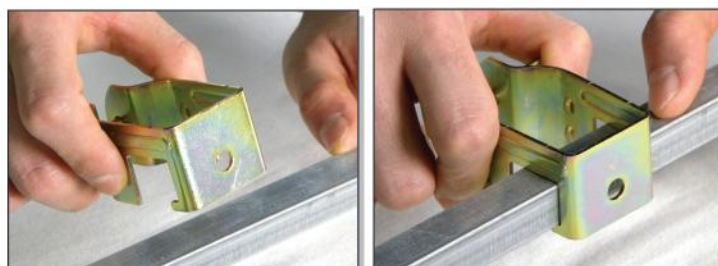

- 7** Place the SBB center bracket at the desired position and insert the outlet reducer into the SBB.

Adjust height for proper position and tighten up a screw of the SBB to secure the hose in place.

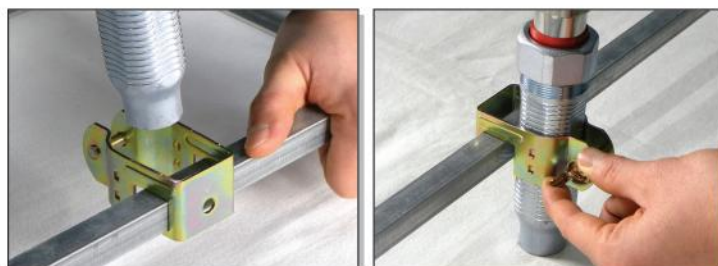

- 8** Install the sprinkler head.  
**USE PTFE tape** or a non-hardening pipe-joint compound.

Refer to the NFPA guidelines and sprinkler head manufacturer's installation instructions for proper installation.

